

Calipers

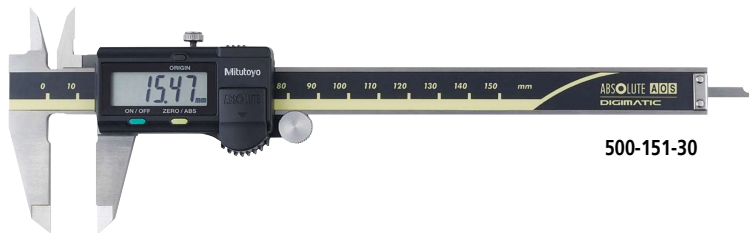

ABSOLUTE Digimatic Caliper SERIES 500 — with exclusive ABSOLUTE Encoder Technology

- The ZERO/ABS button allows the display to be Zero-Set at any slider position along the scale. In addition, no overspeed-errors will occur.
- Carbide-tipped jaw calipers are optimal for rough finished parts, castings, grinding stones, etc.
- Allows integration into statistical process control and measurement systems for models with measurement data output connector. (Refer to page A-3.)



500-151-30

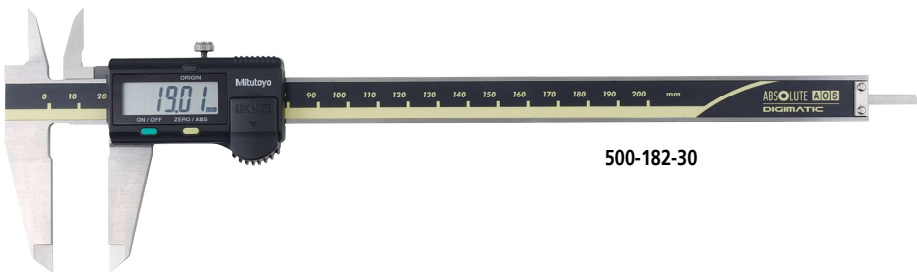

500-182-30

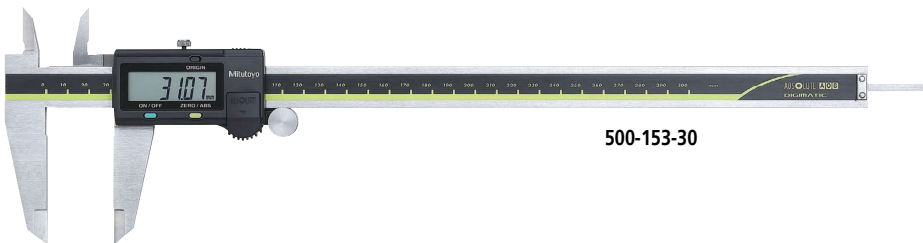

500-153-30

SPECIFICATIONS

Metric									
Order No.	Range (mm)	Resolution (mm)	Maximum permissible error (mm) ^{*2}		Mass (g)	Depth bar	Fine adjustment	Remarks	
			<i>E</i> _{MPE}	<i>S</i> _{MPE}					
500-150-30	0 - 100	0.01	±0.02	±0.04	143	∅1.9 mm rod	with thumb roller	—	
500-180-30 ^{*1}									
500-151-30	0 - 150				168	Blade	with thumb roller	Carbide-tipped jaws for outside measurement	
500-154-30								Carbide-tipped jaws for outside and inside measurement	
500-155-30								—	
500-158-30								—	
500-181-30 ^{*1}	0 - 200				198	Blade	with thumb roller	Carbide-tipped jaws for outside measurement	
500-152-30								Carbide-tipped jaws for outside and inside measurement	
500-156-30								—	
500-157-30	0 - 300				350	±0.03	±0.05	—	with thumb roller
500-182-30 ^{*1}									
500-153-30									

- Battery: SR44 (1 pc.), **938882**, for initial operational checks (standard accessory)
- Scale type: ABSOLUTE electromagnetic induction linear encoder
- Battery life: Approx. 5 years under normal use
- Max. response speed: Unlimited
- *1 Without SPC data output
- *2 Partial Surface Contact Error, *E*_{MPE} and Shift Error, *S*_{MPE} are terms (notations) used in ISO 13385-1:2019.

Functions

- Absolute measurement
- Incremental measurement
- Low-voltage alert
- Data output
- Note: See SPECIFICATIONS for excluded items.
- Data hold

Optional Accessories

(Note: Usable only for models with SPC data output. Refer to page A-21 for details.)

Order No.	Type	Description
959149	C	Connecting cables for IT/DP/MUX (1 m)
959150	C	Connecting cables for IT/DP/MUX (2 m)
06AFM380C	C	USB Input Tool Direct (2 m)
02AZD790C	C	Connecting cables for U-WAVE-T (160 mm)
02AZE140C	C	Connecting cables for U-WAVE-T For foot switch
264-621	Buzzer	U-WAVE-TC
264-625	Buzzer	U-WAVE-TCB
02AZF300	Buzzer	Connecting unit for U-WAVE-TC/TCB

Data hold unit

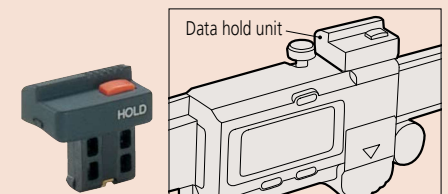

959143

Inch / Metric		Resolution	Maximum permissible error*2		Mass (g)	Depth bar	Fine adjustment	Remarks				
Order No.	Range		EMPE	SMPE								
500-170-30	0 - 4 in/ 0 - 100 mm	0.0005 in/ 0.01 mm	±0.001 in/ ±0.02 mm	±0.002 in/ ±0.04 mm	143	∅0.075 inch rod	with thumb roller	—				
500-195-30*1												Carbide-tipped jaws for outside measurement
500-171-30										Carbide-tipped jaws for outside and inside measurement		
500-174-30										—		
500-175-30										Carbide-tipped jaws for outside measurement		
500-178-30	0 - 6 in/ 0 - 150 mm								168	∅0.075 inch rod	Carbide-tipped jaws for outside and inside measurement	
500-196-30*1												—
500-159-30*1											Carbide-tipped jaws for outside measurement	
500-160-30*1											Carbide-tipped jaws for outside and inside measurement	
500-172-30											—	
500-176-30											Carbide-tipped jaws for outside measurement	
500-177-30											Carbide-tipped jaws for outside and inside measurement	
500-197-30*1	0 - 8 in/ 0 - 200 mm								198	Blade	—	
500-163-30*1												Carbide-tipped jaws for outside measurement
500-164-30*1												Carbide-tipped jaws for outside and inside measurement
500-173-30												—
500-167-30							Carbide-tipped jaws for outside measurement					
500-168-30							Carbide-tipped jaws for outside and inside measurement					
500-193-30*1	0 - 12 in/ 0 - 300 mm				350		—					
500-165-30*1								Carbide-tipped jaws for outside measurement				
500-166-30*1								Carbide-tipped jaws for outside and inside measurement				

- Battery: SR44 (1 pc.), **938882**, for initial operational checks (standard accessory)
- Scale type: ABSOLUTE electromagnetic induction linear encoder
- Battery life: Approx. 5 years under normal use
- Max. response speed: Unlimited
- *1 Without SPC data output
- *2 Partial Surface Contact Error, $EMPE$ and Shift Error, $SMPE$ are terms (notations) used in ISO 13385-1:2019.

DIMENSIONS

