

Calipers

Point Caliper SERIES 573, 536 — ABSOLUTE Digimatic and vernier types

- Narrow-tip jaws fit into very small grooves and tracks.
- Allows step measurement.
- Digimatic models are IP67 Absolute type. Slider action is smooth, firm and comfortable.



SPECIFICATIONS

Metric		Digimatic model		
Order No.	Range (mm)	Resolution (mm)	Maximum permissible error (mm)*2	
			EMPE	SMPE
573-621-20	0 - 150	0.01	±0.02	±0.04
573-625-20	0 - 150		±0.02	±0.04
573-622-20*1	0 - 150		±0.02	±0.04
573-626-20*1	0 - 150		±0.02	±0.04

Inch / Metric		Digimatic model		
Order No.	Range	Resolution	Maximum permissible error*2	
			EMPE	SMPE
573-721-20	0 - 6 in/0 - 150 mm	0.0005 in/0.01 mm	±0.001 in/±0.02 mm	±0.002 in/±0.04 mm
573-725-20			±0.001 in/±0.02 mm	±0.002 in/±0.04 mm

- Dust/Water protection level: IP67 (IEC 60529)*3
- Battery: SR44 (1 pc.), **938882**, for initial operational checks (standard accessory)
- Battery life: Approx. 5 years under normal use
- Scale type: ABSOLUTE electromagnetic induction linear encoder
- Max. response speed: Unlimited
- With depth bar
- *1 Without thumb roller
- *2 Partial Surface Contact Error, EMPE and Shift Error, SMPE are terms (notations) used in ISO 13385-1:2019.
- *3 Rustproofing shall be applied after use if caliper was in contact with coolant.

DIMENSIONS

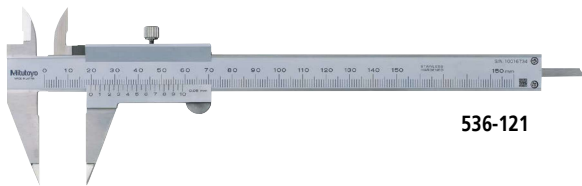
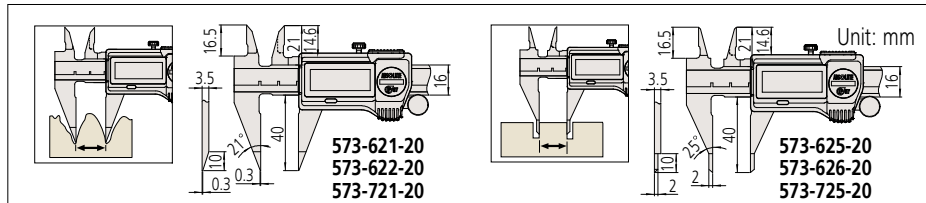

SPECIFICATIONS

Metric		Analog model		
Order No.	Range (mm)	Graduation (mm)	Maximum permissible error (mm)*	
			EMPE	SMPE
536-121	0 - 150	0.05	±0.05	±0.07

- With depth bar
- * Partial Surface Contact Error, EMPE and Shift Error, SMPE are terms (notations) used in ISO 13385-1:2019.

DIMENSIONS

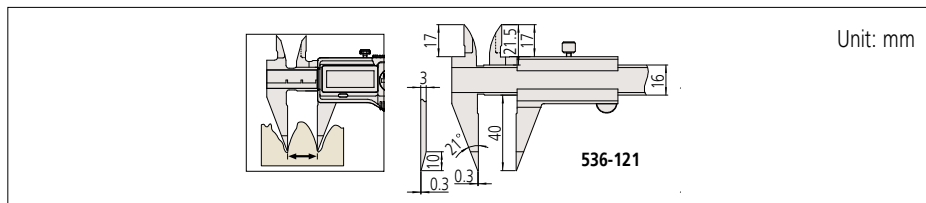

ABSOLUTE™

Applicable models: series 573



Measurement example



Optional Accessories (for series 573)

Order No.	Type	Description
05CZA624	A	Connecting cables for IT/DP/MUX (1 m)
05CZA625	A	Connecting cables for IT/DP/MUX (2 m)
06AFM380A	A	USB Input Tool Direct (2 m)
02AZD790A	A	Connecting cables for U-WAVE-T (160 mm)
02AZE140A	A	Connecting cables for U-WAVE-T For foot switch
264-620	IP67	U-WAVE-TC
264-621	Buzzer	U-WAVE-TC
264-624	IP67	U-WAVE-TCB Transmitter
264-625	Buzzer	U-WAVE-TCB Transmitter
02AZF310	IP67	Connecting unit for U-WAVE-TC/TCB