



## SERIES 2 — Standard Type, Inch Reading

### SPECIFICATIONS

Inch		ANSI/AGD type						
Order No.		Graduation (in)	Range (range/rev) (in)	Accuracy (in)		Repeat-ability (in)	Dial reading	Measuring force (N)
w/lug	Flat-back			First 1 Rev/2.5 Rev/10 Rev	Retrace			
2414A	2414AB	0.001	0.5 (0.1)	±0.001/±0.001/±0.001	0.0002	±0.0002	±0-100	1.8 or less
2415A	2415AB	0.001	0.5 (0.1)	±0.001/±0.001/±0.001	0.0002	±0.0002	0-50-0	1.8 or less
2914A	2914AB	0.001	0.5 (0.1)	±0.001/±0.001/±0.001	0.0002	±0.0002	100-0	1.8 or less
2506A	2506AB	0.0005	0.125 (0.05)	±0.0005/±0.0005/—	0.00016	±0.0001	±0-50	1.8 or less
2507A	2507AB	0.0005	0.125 (0.05)	±0.0005/±0.0005/—	0.00016	±0.0001	0-25-0	1.8 or less
2514A	2514AB	0.0005	0.5 (0.05)	±0.0005/±0.0005/±0.0015	0.00016	±0.0001	±0-50	1.8 or less
2922A	2922AB	0.0005	0.125 (0.05)	±0.0005/±0.0005/—	0.00016	±0.0001	0-25-0	1.8 or less
2356A-10	2356AB-10	0.0001	0.25 (0.01)	±0.0002/±0.0002/±0.0003/±0.0004 (First 20rev)/±0.0005 (Over 20rev)	0.0001	±0.00003	0-10	2.0 or less
2358A-10	2358AB-10	0.0001	0.5 (0.01)	±0.0002/±0.0002/±0.0003/±0.0004 (First 20rev)/±0.0008 (Over 20rev)	0.00015	±0.00003	0-10	2.0 or less
2802A-10	2802AB-10	0.0001	0.025 (0.01)	±0.0001/±0.0001/—	0.0001	±0.00003	0-10	2.0 or less
2803A-10	2803AB-10	0.0001	0.025 (0.01)	±0.0001/±0.0001/—	0.0001	±0.00003	0-5-0	2.0 or less
2804A-10	2804AB-10	0.0001	0.05 (0.01)	±0.0001/±0.0001/±0.0002	0.0001	±0.00003	0-10	2.0 or less
2805A-10	2805AB-10	0.0001	0.05 (0.01)	±0.0001/±0.0001/±0.0002	0.0001	±0.00003	0-5-0	2.0 or less
2905A-10	2905AB-10	0.0001	0.05 (0.01)	±0.0001/±0.0001/±0.0002	0.0001	±0.00003	10-0	2.0 or less
2923A-10	2923AB-10	0.0001	0.05 (0.01)	±0.0001/±0.0001/±0.0002	0.0001	±0.00003	0-5-0	2.0 or less

Note: Completed products inspection is performed in the vertical orientation (contact point downward) and the stated accuracy is guaranteed.

### FEATURES

Inch							
Order No.							
w/lug	Flat-back						
2414A	2414AB				✓		✓
2415A	2415AB					✓	✓
2914A	2914AB		✓				✓
2506A	2506AB				✓		✓
2507A	2507AB					✓	✓
2514A	2514AB				✓		✓
2922A	2922AB					✓	✓
2356A-10	2356AB-10			✓	✓		✓
2358A-10	2358AB-10			✓	✓		✓
2802A-10	2802AB-10	✓		✓	✓		
2803A-10	2803AB-10	✓		✓		✓	
2804A-10	2804AB-10	✓		✓	✓		
2805A-10	2805AB-10	✓		✓		✓	
2905A-10	2905AB-10	✓	✓	✓			
2923A-10	2923AB-10	✓		✓		✓	

# Dial Indicators

## DIMENSIONS

ANSI/AGD  
Type

Unit: in

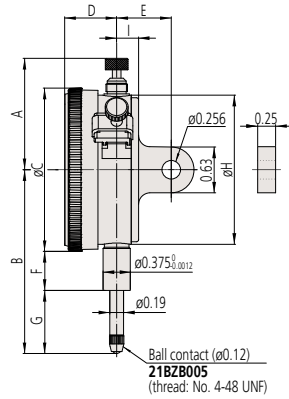

Order No.	A	B	C	D	E	F	G	H	I	Mass (g)	
										w/lug	Flat-back
2414A	1.53	2.52	2.24	0.71	3/4	0.54	0.87	2.05	0.30	164	139
2415A	1.53	2.52	2.24	0.71	3/4	0.54	0.87	2.05	0.30	164	139
2914A	1.53	2.52	2.24	0.71	3/4	0.54	0.87	2.05	0.30	164	139
2506A	1.86	2.14	2.24	0.71	3/4	0.54	0.48	2.05	0.30	164	139
2507A	1.86	2.14	2.24	0.71	3/4	0.54	0.48	2.05	0.30	164	139
2514A	1.53	2.52	2.24	0.71	3/4	0.54	0.87	2.05	0.30	164	139
2922A	1.86	2.14	2.24	0.71	3/4	0.54	0.48	2.05	0.30	164	139
2356A-10	1.86	2.25	2.24	0.71	3/4	0.54	0.59	2.05	0.30	163	138
2358A-10	1.53	2.50	2.24	0.71	3/4	0.54	0.85	2.05	0.30	164	139
2802A-10	1.86	2.02	2.24	0.71	3/4	0.54	0.37	2.05	0.30	164	139
2803A-10	1.86	2.02	2.24	0.71	3/4	0.54	0.37	2.05	0.30	164	139
2804A-10	1.86	2.04	2.24	0.71	3/4	0.54	0.38	2.05	0.30	166	141
2805A-10	1.86	2.04	2.24	0.71	3/4	0.54	0.38	2.05	0.30	166	141
2905A-10	1.86	2.04	2.24	0.71	3/4	0.54	0.38	2.05	0.30	164	139
2923A-10	1.86	2.04	2.24	0.71	3/4	0.54	0.38	2.05	0.30	164	139